

Multiple Sheet cutting function on Vulcan flatbed cutters

Required Firmware: 1.00.16

The Multi-sheet Function offers the possibility to place multiple sheets on a Vulcan FC500 or Vulcan FC700 flatbed cutter and have these automatically cut one after the other. On the FC500 usually 2 sheets of A3 or SRA3 are used whereas the FC700 can cut up to 4 sheets in a row and then return to the origin. Then the next 4 sheets can be inserted for sequential cutting.

The multi-sheet function is controlled by the cutter firmware and is accessed by pressing the force-section on the control panel for a few seconds.

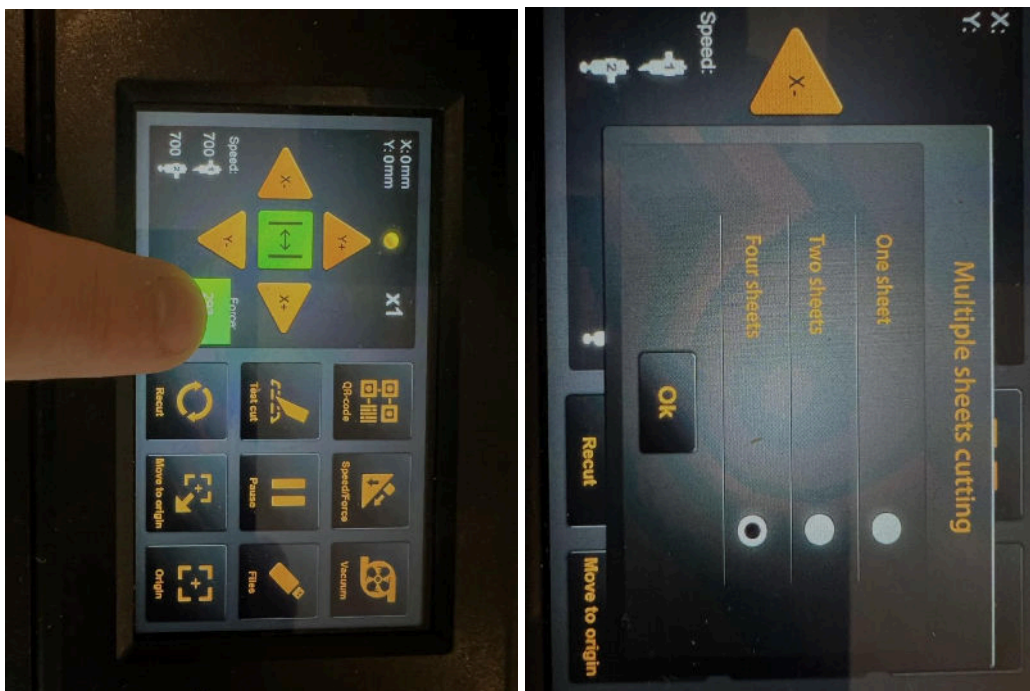

SignCut:

Make sure the distance between copies is set to 0 and Feed forward after cut is also set to 0.

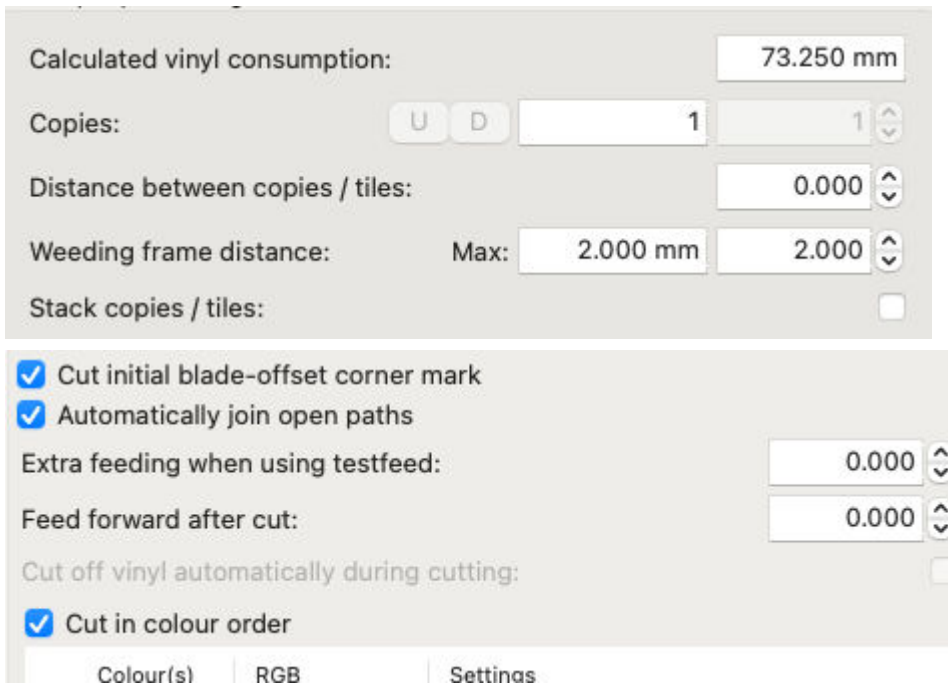

Calculated vinyl consumption: 73.250 mm

Copies: U D 1 1

Distance between copies / tiles: 0.000

Weeding frame distance: Max: 2.000 mm 2.000

Stack copies / tiles:

Cut initial blade-offset corner mark

Automatically join open paths

Extra feeding when using testfeed: 0.000

Feed forward after cut: 0.000

Cut off vinyl automatically during cutting:

Cut in colour order

Colour(s) | RGB | Settings

It is also important to set the registration marks in the corners of the material, 10mm from the edge, so the distance between the marks of the sheets is 20mm.

4-sheet mode:

Layout has to be created in portrait orientation

After finishing sheet number 1, the machine will search for mark 1 of sheet 2 at 20mm to the left of mark 2 of sheet 1.

After finishing sheet 2, the machine will search for mark 1 of sheet 3 20 mm to the top of mark 3 of sheet 2

After finishing sheet 3, the machine will search for mark 1 of sheet 4 at 20mm + the size of the sheet right of mark 4 of sheet 3.

Basically just align all 4 sheets next to each other, so marks 3 (sheet 1), 4 (sheet 2), 1 (sheet 3) and 2 (sheet 4) meet in the center of the cutter

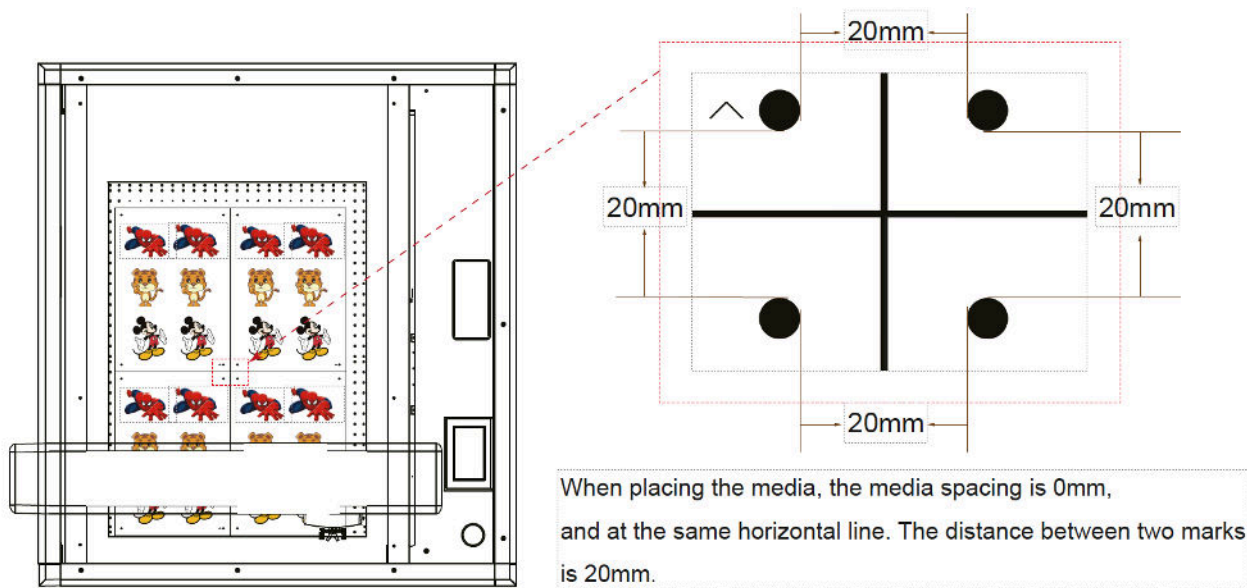

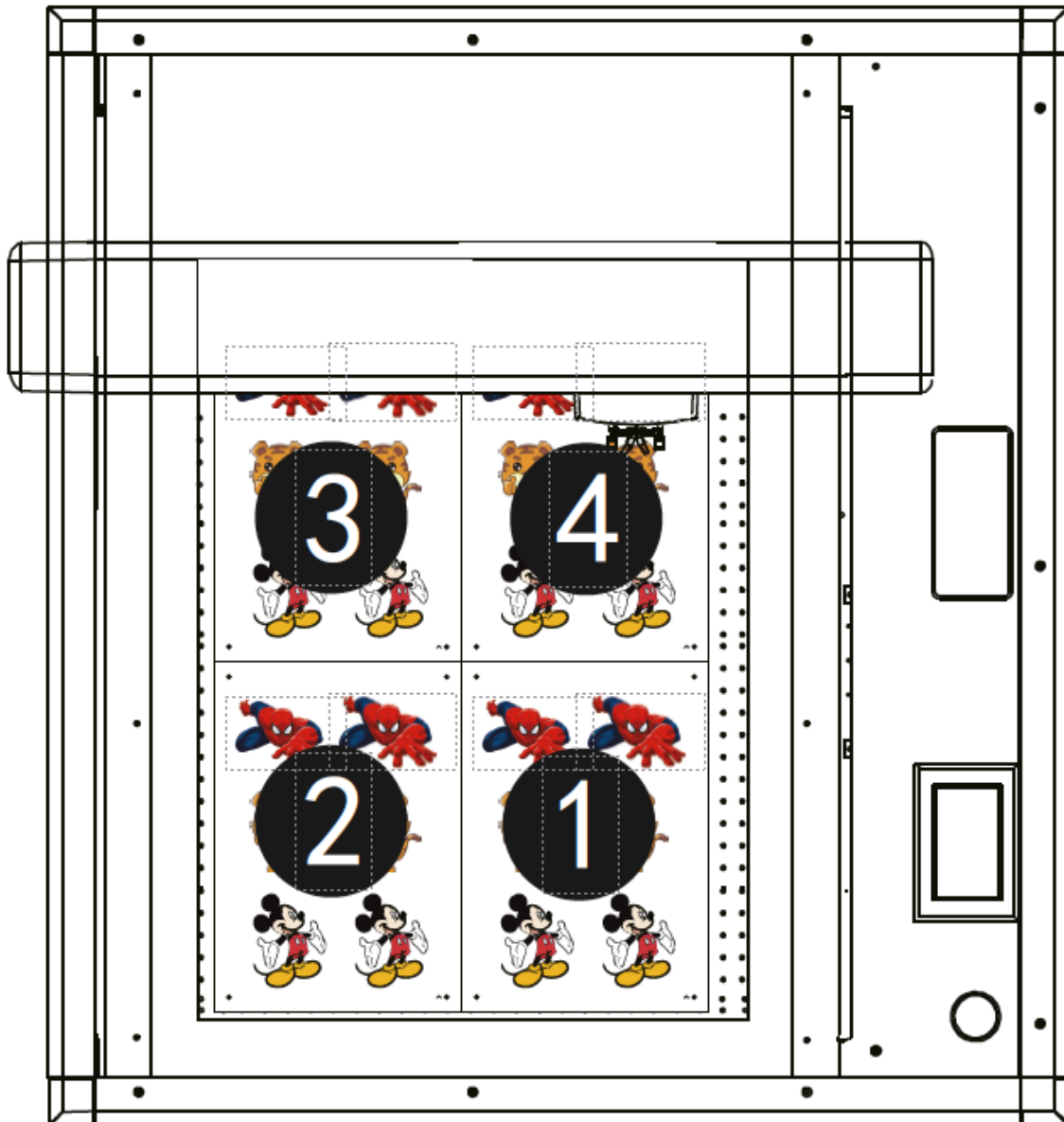

2-sheet mode:

Nepata Systems GmbH
Hochstatt 6-8
D-85283 Wolnzach
HRB: 4700 Ingolstadt

Tel: +49 8442 96090-30
Fax: +49 8442 95840 26
E-Mail: systems@nepata.de
Web: www.nepata.de

VR Bayern Mitte e.G.
IBAN: DE93721608180003010244
BIC: GENODEF1INP
Ust-ID: DE24 8022 184

Geschäftsführer:
Dipl. Ing. Fabian Franke,
Dipl. Ing. (FH) Bernhard Schmidt,
Oliver Tiedemann, MBA

Layout has to be created in landscape orientation:

After finishing sheet number 1, the machine will search for mark 1 of sheet 2 at 20mm top of mark 4 of sheet 1.

Place the sheets in landscape orientation on the machine next to each other

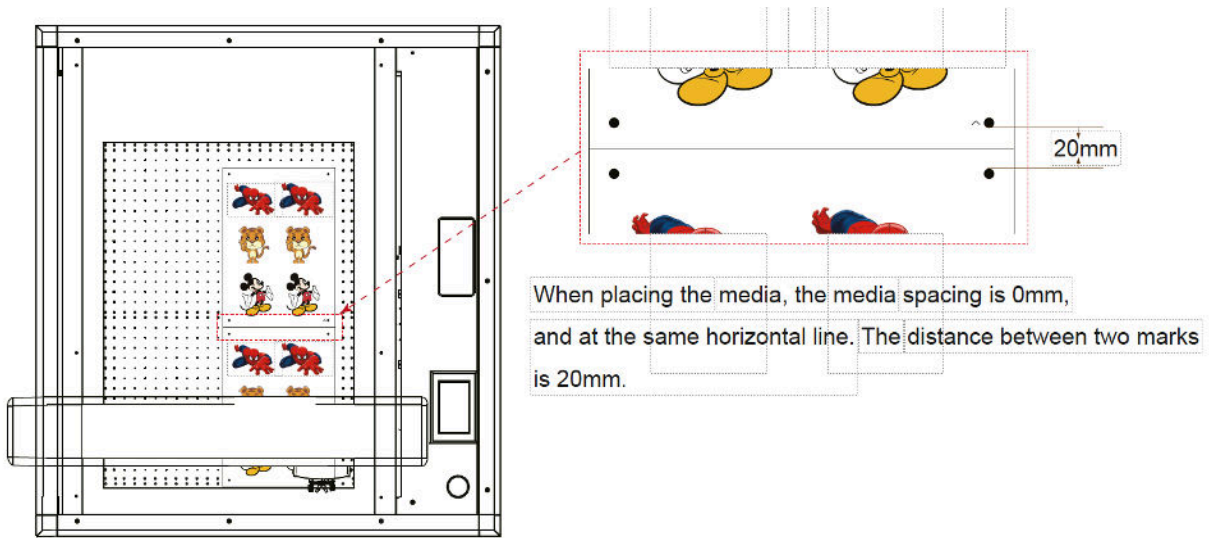

QR-Codes:

It is important to use the QR code function for the multi-cut function and have the machine retrieve the correct PLT file from the USB-Disk or from the hotfolder. The machine will read the QR code for every single sheet to ensure the correct design is cut.

Please note that the multi-sheet function only works for PLT files that are cut from USB-stick or from network hotfolder.